

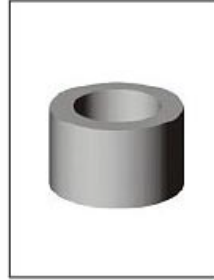

Cemented Carbide BM-A Model Batteries Punching Dies

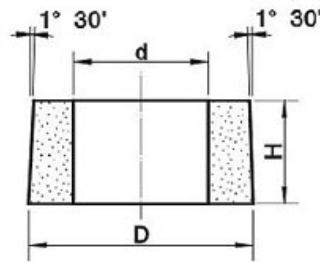

Unit: mm

Type	d	D	H
CTC-GΦ10×Φ64.6×35.6	10	64.6	35.6
CTC-GΦ12.5×Φ30×20	12.5	30	20
CTC-GΦ12.5×Φ30×24	12.5	30	24
CTC-GΦ12.8×Φ30×20	12.8	30	20
CTC-GΦ12.9×Φ30×24.5	12.9	30	24.5
CTC-GΦ12.9×Φ35.3×20	12.9	35.3	20
CTC-GΦ13×Φ24.5×20	13	24.5	20
CTC-GΦ13.5×Φ30×24	13.5	30	24
CTC-GΦ17×Φ28.5×24.5	17	28.5	24.5
CTC-GΦ19.7×Φ58.9×18	19.7	58.9	18
CTC-GΦ20×Φ80×60	20	80	60
CTC-GΦ23.8×Φ40×20	23.8	40	20
CTC-GΦ23.8×Φ40×20	23.8	40	20
CTC-GΦ24×Φ39×32	24	39	32
CTC-GΦ24×Φ67.2×26	24	67.2	26
CTC-GΦ26×Φ41×40	26	41	40
CTC-GΦ26.9×Φ72.2×25	26.9	72.2	25
CTC-GΦ28.8×Φ55.2×18	28.8	55.2	18
CTC-GΦ29×Φ67.3×25	29	67.3	25
CTC-GΦ29.4×Φ55.7×21	29.4	55.7	21
CTC-GΦ30.5×Φ48×20	30.5	48	20
CTC-GΦ30.5×Φ48×20	30.5	48	20
CTC-GΦ30.8×Φ47×20	30.8	47	20
CTC-GΦ31.2×Φ47×20	31.2	47	20
CTC-GΦ31.2×Φ50×28	31.2	50	28
CTC-GΦ31.3×Φ46.8×20	31.3	46.8	20
CTC-GΦ31.4×Φ48×20	31.4	48	20
CTC-GΦ31.4×Φ49×18	31.4	49	18
CTC-GΦ31.8×Φ47×20	31.8	47	20
CTC-GΦ31.9×Φ49.4×14.5	31.9	49.4	14.5
CTC-GΦ31.9×Φ50.4×28.5	31.9	50.4	28.5



Continued

Unit: mm

Type	d	D	H
CTC-G Φ 32.2 \times Φ 48 \times 20	32.2	48	20
CTC-G Φ 32.2 \times Φ 48 \times 20	32.2	48	20
CTC-G Φ 32.2 \times Φ 48 \times 20	32.2	48	20
CTC-G Φ 33.5 \times Φ 63 \times 28	33.5	63	28
CTC-G Φ 38.5 \times Φ 67.4 \times 25	38.5	67.4	25
CTC-G Φ 33.6 \times Φ 62.4 \times 25	33.6	62.4	25
CTC-G Φ 36.7 \times Φ 67.8 \times 27	36.7	67.8	27
CTC-G Φ 39.2 \times Φ 62 \times 23	39.2	62	23

Tolerance: d: -2.0~0; D: -1.3~+1.4; curvature: ≤ 0.55