

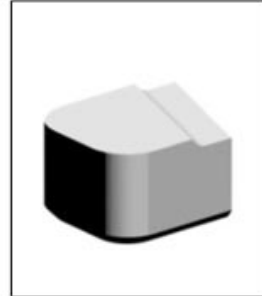

Cemented Carbide Brazed Tip-Type E7-2

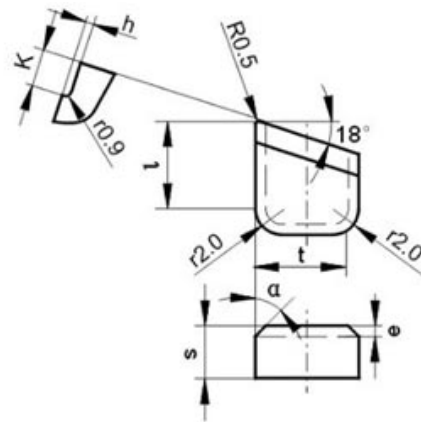

Unit: mm

Type	L	t	s	e	K	H
CTC-GE707-2	7.1	6.0	4.0	0.5	1.8	0.4
CTC-GE709-2	9.5	8.5	4.5	0.5	2.2	0.5
CTC-GE713-2	13.7	10.5	4.5	1.0	2.3	0.6

Tolerance: ± 1.3