

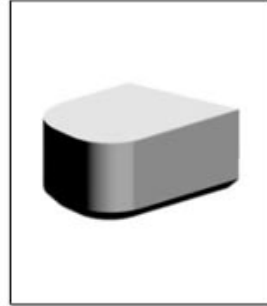

Cemented Carbide Brazed Tip-Type E7

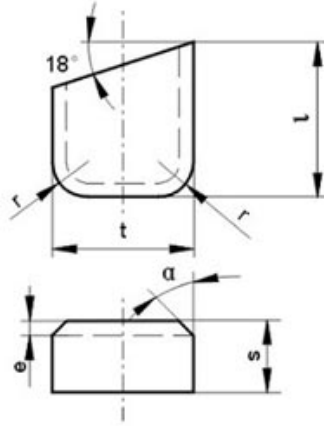

Unit: mm

Type	L	t	s	r	e	α
CTC-GE706	6.0	5.0	3.5	2.0	0.5	45°
CTC-GE707	7.0	5.0	3.5	2.0	0	0°
CTC-GE707A	7.5	6.0	5.0	1.0	0	0°
CTC-GE707B	7.0	7.5	5.0	2.0	1.0	45°
CTC-GE708	8.0	5.5	3.5	2.0	0	0°
CTC-GE708A	8.0	7.0	4.0	2.0	0	0°
CTC-GE709	9.0	9.0	4.0	2.0	0	0°
CTC-GE710	10.0	8.0	5.0	1.0	0	0°
CTC-GE711	11.0	10.0	5.0	2.0	1.0	30°
CTC-GE713	13.0	13.0	5.0	2.0	0	0°
CTC-GE715	15.0	14.0	5.0	2.0	0	0°
CTC-GE716	16.0	14.0	5.0	2.5	0	0°
CTC-GE716A	16.0	15.0	5.0	2.5	0	0°

Tolerance: ± 1.3