

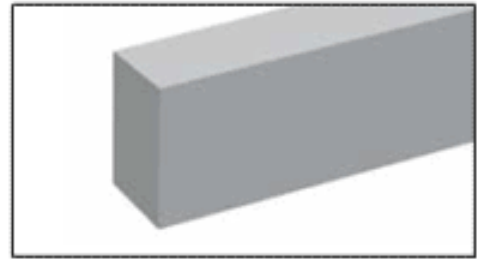

Cemented Carbide Gauge Block-Type LK



Unit: mm

Type	B	L	S
CTC-SLK0250502	2.5	5.0	2.0
CTC-SLK0250602		6.0	
CTC-SLK0250802		8.0	
CTC-SLK0251002		10.0	
CTC-SLK0251602		16.0	
CTC-SLK0300503	3.0	5.0	3.0
CTC-SLK0300602		6.0	2.5
CTC-SLK0300603			3.0
CTC-SLK0300802		8.0	2.5
CTC-SLK0301002		10.0	
CTC-SLK0301003			3.0
CTC-SLK0301202		12.0	2.5
CTC-SLK0301203			3.0
CTC-SLK0301602		16.0	2.5
CTC-SLK0301603			3.0
CTC-SLK0400503	4.0	5.0	3.0
CTC-SLK0400602		6.0	
CTC-SLK0400603			
CTC-SLK0400803		8.0	2.5
CTC-SLK0401002		10.0	
CTC-SLK0401003			3.0
CTC-SLK0401202		12.0	2.5
CTC-SLK0401602		16.0	2.5
CTC-SLK0401603			3.5
CTC-SLK0402004		20.0	4.0
CTC-SLK0402504	25.0		
CTC-SLK0500503	5.0	5.0	3.0
CTC-SLK0500603		6.0	
CTC-SLK0501003		10.0	
CTC-SLK0501203		12.0	



Continued

Unit: mm

Type	B	L	S
CTC-SLK0501603	5.0	16.0	3.0
CTC-SLK0501604			4.0
CTC-SLK0502003		20.0	3.5
CTC-SLK0502004			4.0
CTC-SLK0502503		25.0	3.5
CTC-SLK0502504			4.0
CTC-SLK0600603	6.0	6.0	3.0
CTC-SLK0600803		8.0	
CTC-SLK0601003		10.0	
CTC-SLK0601203		12.0	3.5
CTC-SLK0601603		16.0	
CTC-SLK0601803		18.0	
CTC-SLK0602003		20.0	
CTC-SLK0602503		25.0	4.0
CTC-SLK0602504			
CTC-SLK0801603		8.0	16.0
CTC-SLK0802503	25.0		4.0
CTC-SLK0802504			4.0
CTC-SLK0953002	9.0	12.0	2.5
CTC-SLK0953003	9.5	30.5	3.0
CTC-SLK0953004			4.0
CTC-SLK0953005			5.0
CTC-SLK0953006			6.0
CTC-SLK0953007			7.0
CTC-SLK0953008			8.0
CTC-SLK1203004	12.0		
CTC-SLK1402804	14.0	28.0	4.0
CTC-SLK1501804	15.0	18.0	
CTC-SLK1802505	18.0	25.0	5.0
CTC-SLK1803005		30.5	
CTC-SLK1803505		35.0	
CTC-SLK2003010	20.0	30.5	10.0
CTC-SLK2003510		35.0	
CTC-SLK2503510	25.0		
CTC-SLK3003510	30.0		
CTC-SLK3504010	35.0	40.0	

Tolerance: 0~+0.90