

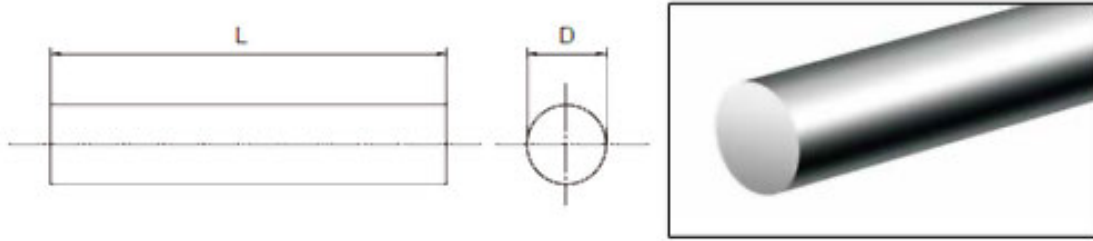

### Cemented Carbide Rods for PCB Tools



Unit: mm

| Type            | D    | L     |
|-----------------|------|-------|
| CTC-BΦ3.25×38.7 | 3.25 | 38.7  |
| CTC-BΦ3.5×38.5  | 3.50 | 38.5  |
| CTC-BΦ4.0×38.5  | 4.00 | 38.5  |
| CTC-BΦ4.5×38.5  | 4.50 | 38.5  |
| CTC-BΦ5.0×38.5  | 5.00 | 38.5  |
| CTC-BΦ5.5×38.5  | 5.50 | 38.5  |
| CTC-BΦ6.0×38.5  | 6.00 | 38.5  |
| CTC-BΦ6.5×38.5  | 6.50 | 38.5  |
| CTC-BΦ1.2×110   | 1.20 | 110.0 |
| CTC-BΦ1.35×110  | 1.35 | 110.0 |
| CTC-BΦ1.5×110   | 1.50 | 110.0 |
| CTC-BΦ1.8×110   | 1.80 | 110.0 |
| CTC-BΦ2.0×110   | 2.00 | 110.0 |

Tolerance: D: 0~+0.25; L:-0.02~+2