

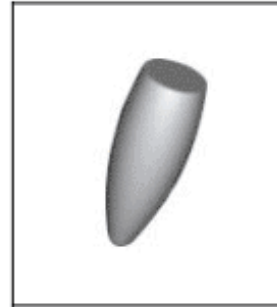

Cemented Carbide Rotary Teeth-Type H

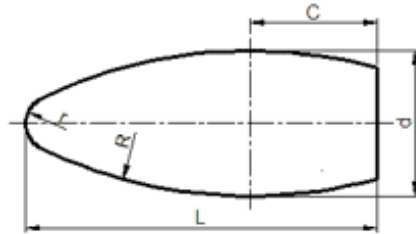

Unit: mm

Type	d	L	r	R	C
CTC-NH0820	8.5	20.5	1.5	32	6.4
CTC-NH1025	10.5	25.5	2.0	34	9.5
CTC-NH1232	12.5	32.5	2.5	39	13.9
CTC-NH1636	16.5	36.5	2.5	41	13.6

Tolerance: d: +0.2~+0.6; L: ±0.3