

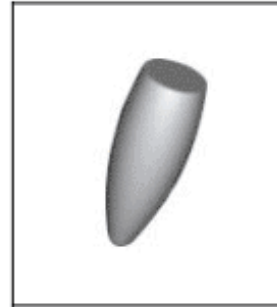

Cemented Carbide Rotary Teeth-Type H

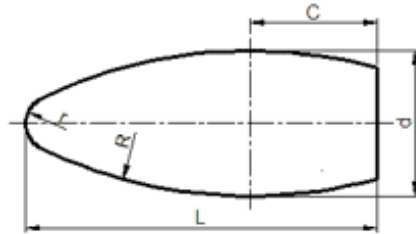

Unit: mm

Type	d	L	r	R	C
CTC-SH0820	8.5	20.5	2.0	32	7.1
CTC-SH1025	10.5	25.5	2.0	35	9.2
CTC-SH1232	12.5	32.5	2.5	40	13.65
CTC-SH1636	16.5	36.5	2.5	41	13.75

Tolerance: d: 0~+0.5; L: ±0.3