

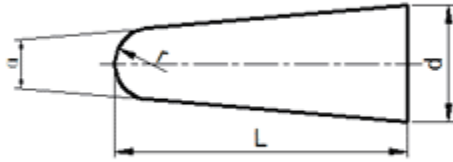

Cemented Carbide Rotary Teeth-Type L



Unit: mm

Type	d	L	r	a
CTC-SL0616	6.5	16.5	2.0	10°
CTC-SL0822	8.5	22.5		12°13'
CTC-SL1025	10.5	25.5	2.4	14°
CTC-SL1228	12.5	28.5	3.1	14°
CTC-SL1633	16.5	33.5	4.7	14°

Tolerance: d: 0~+0.5; L: ±0.3