

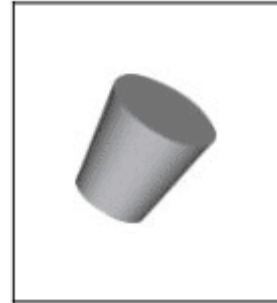

Cemented Carbide Rotary Teeth-Type S

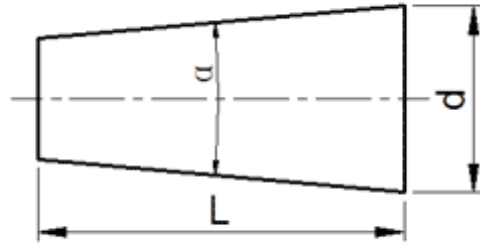

Unit: mm

| Type | d | L | α° |
|------------|------|------|----------------|
| CTC-NS0614 | 6.5 | 14.5 | 20 |
| CTC-NS0817 | 8.5 | 17.5 | 8 |
| CTC-NS1020 | 10.5 | 20 | 12 |
| CTC-NS1205 | 12.5 | 5 | 22 |
| CTC-NS1220 | 12.5 | 20.5 | 16 |
| CTC-NS1428 | 14.5 | 28 | 16 |
| CTC-NS1606 | 16.5 | 6 | 22 |

Tolerance: d: +0.4; L: ± 0.3