

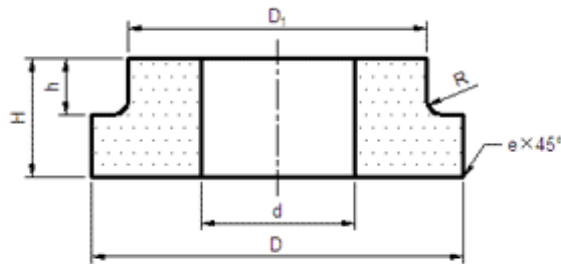

Cemented Carbide Seal Ring-Type HT



Unit: mm

| Type | D | d | H | D1 | R | h |
|-----------------|-------|-------|------|-------|-----|-----|
| CTC-YHT03102207 | 31.0 | 22.0 | 7.5 | 26.0 | 1.0 | 2.8 |
| CTC-YHT03903007 | 39.0 | 30.0 | 7.5 | 34.0 | 1.0 | 2.8 |
| CTC-YHT05003608 | 50.0 | 36.0 | 8.0 | 42.0 | 1.0 | 2.5 |
| CTC-YHT05504108 | 55.0 | 41.0 | 8.0 | 47.0 | 1.0 | 2.5 |
| CTC-YHT06004608 | 60.0 | 46.0 | 8.0 | 52.0 | 1.0 | 2.5 |
| CTC-YHT06505108 | 65.0 | 51.0 | 8.0 | 57.0 | 1.0 | 2.5 |
| CTC-YHT07005608 | 70.0 | 56.0 | 8.0 | 62.0 | 1.0 | 2.5 |
| CTC-YHT07506208 | 75.0 | 62.0 | 8.5 | 67.0 | 1.0 | 2.8 |
| CTC-YHT11309710 | 113.0 | 97.0 | 10.0 | 108.0 | 1.0 | 2.0 |
| CTC-YHT13311312 | 133.0 | 113.0 | 12.0 | 124.0 | 1.0 | 3.0 |
| CTC-YHT19171113 | 191.0 | 171.0 | 13.0 | 182.0 | 1.0 | 2.5 |

Tolerance: D: 0~+3.5; d: -1.4~+1.3; H: 0~+1.8