

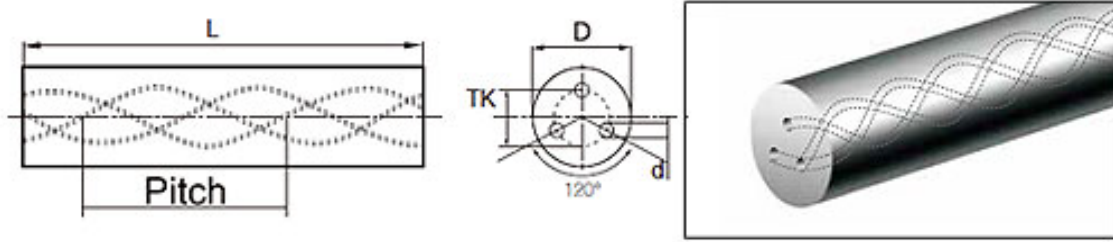

Cemented Carbide Rods with Three Helical Coolant Holes(30°)



Unit: mm

Type	D	TK	d	L	Pitch
CTC-WΦ4.8×3Φ0.4×2.2×L	4.8	2.20	0.40	310/330	24.49
CTC-WΦ5.3×3Φ0.4×2.45×L	5.3	2.45	0.40	310/330	27.21
CTC-WΦ5.8×3Φ0.5×2.75×L	5.8	2.75	0.50	310/330	29.93
CTC-WΦ6.3×3Φ0.5×2.75×L	6.3	2.75	0.50	310/330	32.65
CTC-WΦ6.8×3Φ0.5×2.75×L	6.8	2.75	0.50	310/330	35.37
CTC-WΦ7.3×3Φ0.65×3.85×L	7.3	3.85	0.65	310/330	38.09
CTC-WΦ7.8×3Φ0.7×3.85×L	7.8	3.85	0.70	310/330	40.81
CTC-WΦ8.3×3Φ0.7×3.85×L	8.3	3.85	0.70	310/330	43.53
CTC-WΦ8.8×3Φ0.7×3.85×L	8.8	3.85	0.70	310/330	46.25
CTC-WΦ9.3×3Φ0.85×4.95×L	9.3	4.95	0.85	310/330	48.97
CTC-WΦ9.8×3Φ0.85×4.95×L	9.8	4.95	0.85	310/330	51.69
CTC-WΦ10.3×3Φ0.85×4.95×L	10.3	4.95	0.85	310/330	54.41
CTC-WΦ10.8×3Φ0.85×4.95×L	10.8	4.95	0.85	310/330	57.13
CTC-WΦ11.3×3Φ1.1×5.45×L	11.3	5.45	1.10	310/330	59.86
CTC-WΦ11.8×3Φ1.1×5.85×L	11.8	5.85	1.10	310/330	62.58
CTC-WΦ12.3×3Φ1.1×6.05×L	12.3	6.05	1.10	310/330	65.30
CTC-WΦ12.8×3Φ1.1×6.05×L	12.8	6.05	1.10	310/330	68.02
CTC-WΦ13.3×3Φ1.2×6.55×L	13.3	6.55	1.20	310/330	70.74
CTC-WΦ13.8×3Φ1.2×6.75×L	13.8	6.75	1.20	310/330	73.46
CTC-WΦ14.3×3Φ1.4×7.05×L	14.3	7.05	1.40	310/330	76.18
CTC-WΦ14.8×3Φ1.4×7.35×L	14.8	7.35	1.40	310/330	78.90
CTC-WΦ15.3×3Φ1.4×7.55×L	15.3	7.55	1.40	310/330	81.62
CTC-WΦ16.3×3Φ1.6×8.05×L	16.3	8.05	1.60	310/330	87.06
CTC-WΦ17.3×3Φ1.6×8.35×L	17.3	8.35	1.60	310/330	92.50
CTC-WΦ18.3×3Φ1.7×9.25×L	18.3	9.25	1.70	310/330	97.95
CTC-WΦ19.3×3Φ1.7×9.95×L	19.3	9.95	1.70	310/330	103.39
CTC-WΦ20.3×3Φ1.9×9.95×L	20.3	9.95	1.90	310/330	108.83
CTC-WΦ22.3×3Φ2×11.15×L	22.3	11.15	2.00	310/330	119.71
CTC-WΦ23.3×3Φ2×11.45×L	23.3	11.45	2.00	310/330	125.15



Continued

Unit: mm

Type	D	TK	d	L	Pitch
CTC-W Φ 24.3 \times 3 Φ 2 \times 11.75 \times L	24.3	11.75	2.00	310/330	130.59
CTC-W Φ 25.3 \times 3 Φ 2 \times 12.15 \times L	25.3	12.15	2.00	310/330	136.03
CTC-W Φ 26.3 \times 3 Φ 2 \times 12.75 \times L	26.3	12.75	2.00	310/330	141.48
CTC-W Φ 27.3 \times 3 Φ 2.5 \times 13.15 \times L	27.3	13.15	2.50	310/330	146.92
CTC-W Φ 28.3 \times 3 Φ 2.5 \times 13.65 \times L	28.3	13.65	2.50	310/330	152.36
CTC-W Φ 29.3 \times 3 Φ 2.5 \times 14.15 \times L	29.3	14.15	2.50	310/330	157.80
CTC-W Φ 30.3 \times 3 Φ 2.5 \times 14.5 \times L	30.3	14.50	2.50	310/330	163.24
CTC-W Φ 31.3 \times 3 Φ 3 \times 15 \times L	31.3	15.00	3.00	310/330	168.68
CTC-W Φ 32.3 \times 3 Φ 3 \times 15.5 \times L	32.3	15.50	3.00	310/330	174.12
CTC-W Φ 33.3 \times 3 Φ 3 \times 16 \times L	33.3	16.00	3.00	310/330	179.57

Tolerance: D: +0.3~+0.5; TK: 0.1~0.6; d: 0.1~0.3; L: +10