

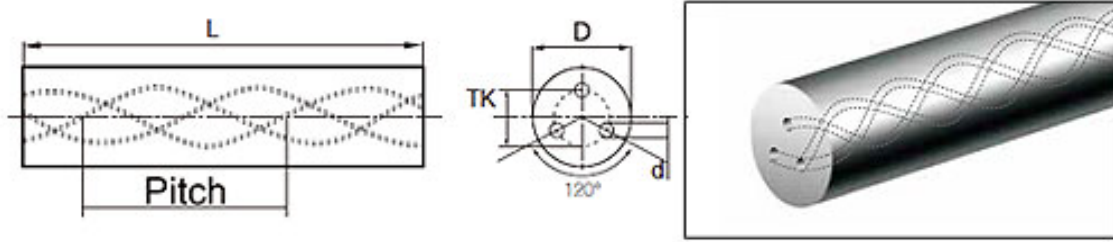

Cemented Carbide Rods with Three Helical Coolant Holes(40°)



Unit: mm

Type	D	TK	d	L	Pitch
CTC-WΦ6.3×3Φ0.5×2.05×L	6.3	2.05	0.50	310/330	22.46
CTC-WΦ6.8×3Φ0.5×2.15×L	6.8	2.15	0.50	310/330	24.34
CTC-WΦ7.3×3Φ0.65×2.25×L	7.3	2.25	0.65	310/330	26.21
CTC-WΦ7.8×3Φ0.65×2.35×L	7.8	2.35	0.65	310/330	28.08
CTC-WΦ8.3×3Φ0.65×2.45×L	8.3	2.45	0.65	310/330	29.95
CTC-WΦ8.8×3Φ0.65×2.75×L	8.8	2.75	0.65	310/330	31.82
CTC-WΦ9.3×3Φ0.75×3.05×L	9.3	3.05	0.75	310/330	33.70
CTC-WΦ9.8×3Φ0.75×3.35×L	9.8	3.35	0.75	310/330	35.57
CTC-WΦ10.3×3Φ0.8×3.35×L	10.3	3.35	0.80	310/330	37.44
CTC-WΦ10.8×3Φ0.8×3.35×L	10.8	3.35	0.80	310/330	39.31
CTC-WΦ11.3×3Φ0.8×3.45×L	11.3	3.45	0.80	310/330	41.18
CTC-WΦ11.8×3Φ0.85×3.75×L	11.8	3.75	0.85	310/330	43.06
CTC-WΦ12.3×3Φ0.9×3.95×L	12.3	3.95	0.90	310/330	44.93
CTC-WΦ12.8×3Φ0.9×4.1×L	12.8	4.10	0.90	310/330	46.80
CTC-WΦ13.3×3Φ0.9×4.15×L	13.3	4.15	0.90	310/330	48.67
CTC-WΦ13.8×3Φ1×4.25×L	13.8	4.25	1.00	310/330	50.54
CTC-WΦ14.3×3Φ1×4.45×L	14.3	4.45	1.00	310/330	52.42
CTC-WΦ14.8×3Φ1.1×4.65×L	14.8	4.65	1.10	310/330	54.29
CTC-WΦ15.3×3Φ1.1×4.85×L	15.3	4.85	1.10	310/330	56.16
CTC-WΦ16.3×3Φ1.2×5.25×L	16.3	5.25	1.20	310/330	59.90
CTC-WΦ17.3×3Φ1.2×5.65×L	17.3	5.65	1.20	310/330	63.65
CTC-WΦ18.3×3Φ1.4×6.05×L	18.3	6.05	1.40	310/330	67.39
CTC-WΦ19.3×3Φ1.4×6.35×L	19.3	6.35	1.40	310/330	71.14
CTC-WΦ20.3×3Φ1.5×6.75×L	20.3	6.75	1.50	310/330	74.88
CTC-WΦ21.3×3Φ1.5×7.05×L	21.3	7.05	1.50	310/330	78.62
CTC-WΦ22.3×3Φ1.7×7.35×L	22.3	7.35	1.70	310/330	82.37
CTC-WΦ24.3×3Φ1.75×7.55×L	24.3	7.55	1.75	310/330	89.86
CTC-WΦ25.3×3Φ1.75×7.65×L	25.3	7.65	1.75	310/330	93.60
CTC-WΦ26.3×3Φ1.75×7.75×L	26.3	7.75	1.75	310/330	97.34



Continued

Unit: mm

Type	D	TK	d	L	Pitch
CTC-W Φ 28.3 \times 3 Φ 2 \times 8.55 \times L	28.3	8.55	2.00	310/330	104.83
CTC-W Φ 30.3 \times 3 Φ 2 \times 9.45 \times L	30.3	9.45	2.00	310/330	112.32
CTC-W Φ 32.3 \times 3 Φ 2 \times 10.45 \times L	32.3	10.45	2.00	310/330	119.81

Tolerance: D: +0.3~+0.5; TK: 0.15~0.55; d: 0.15~0.3; L: +10